

\$279,900 - 11 451 Hyndman Crescent, Edmonton

MLS® #E4440251

\$279,900

2 Bedroom, 2.50 Bathroom, 1,255 sqft
Condo / Townhouse on 0.00 Acres

Canon Ridge, Edmonton, AB

Beautiful end-unit townhouse for sale in Canon Ridge, Edmonton. Backing onto greenspace, this 2-storey home offers 2 spacious primary bedrooms, 2.5 baths, a partially finished basement, and an attached garage. Upgrades include water-resistant laminate, newer paint, appliances, smart switches, and blinds. Enjoy a northwest-facing maintenance-free deck and access to the River Valley trail system, Hermitage Park, schools, shopping, and major routes like Yellowhead and Henday.

Built in 2004

Essential Information

MLS® #	E4440251
Price	\$279,900
Bedrooms	2
Bathrooms	2.50
Full Baths	2
Half Baths	1
Square Footage	1,255
Acres	0.00
Year Built	2004
Type	Condo / Townhouse
Sub-Type	Townhouse
Style	2 Storey
Status	Active

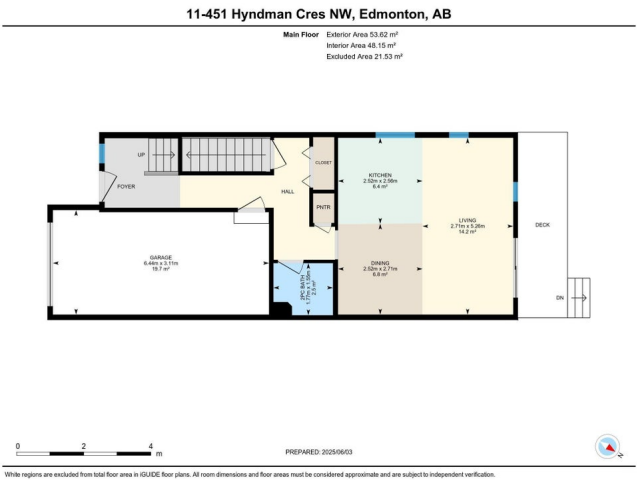

Community Information

Address	11 451 Hyndman Crescent
Area	Edmonton
Subdivision	Canon Ridge
City	Edmonton
County	ALBERTA
Province	AB
Postal Code	T5A 5J3

Amenities

Amenities	Air Conditioner, Deck, Parking-Visitor
Parking Spaces	2
Parking	Insulated, Over Sized, Single Garage Attached

Interior

Interior Features	ensuite bathroom
Appliances	Dryer, Garage Control, Garage Opener, Microwave Hood Fan, Refrigerator, Stove-Electric, Washer, Window Coverings
Heating	Forced Air-1, Natural Gas
Stories	2
Has Basement	Yes
Basement	Full, Partially Finished

Exterior

Exterior	Wood, Vinyl
Exterior Features	Fenced, Landscaped, Park/Reserve, Playground Nearby, Public Transportation, Schools, Shopping Nearby
Roof	Asphalt Shingles
Construction	Wood, Vinyl
Foundation	Concrete Perimeter

Additional Information

Date Listed	June 4th, 2025
Days on Market	40
Zoning	Zone 35
Condo Fee	\$389

DATA IS DEEMED RELIABLE BUT IS NOT GUARANTEED ACCURATE BY THE REALTORS® ASSOCIATION OF EDMONTON. COPYRIGHT 2025 BY THE REALTORS® ASSOCIATION OF EDMONTON. ALL RIGHTS RESERVED. Trademarks are owned or controlled by the Canadian Real Estate Association (CREA) and identify real estate professionals who are members of CREA (REALTOR®, REALTORS®) and/or the quality of services they

provide (MLS®®, Multiple Listing Service®®)
Listing information last updated on July 14th, 2025 at 5:32pm MDT